



Don Stark,
Broker
651-775-1423



Mike Rasmussen
612-718-9520



Elijah Krinitsyn
763-218-1100



Exit Signature Realty

Exit Signature Realty
207 Jefferson Blvd.
Big Lake, MN 55309
763-262-3948 (EXIT)



NOW REPRESENTING DYNAMICS DESIGN & LAND CO.

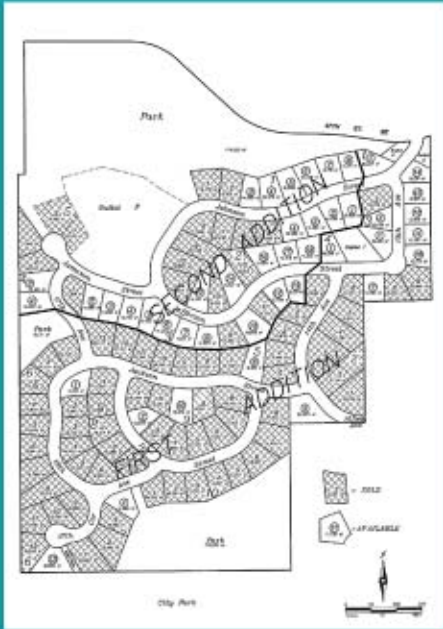

MODEL HOME-AUTUMN RIDGE

13511 Johnson Street, Becker

Elegant rambler totally finished. Hardwood floors, custom cabinets, center island, large master suite, private master bath, full deck, easy landscaping, quality construction and so much more! Call for our open house times. **\$334,900**

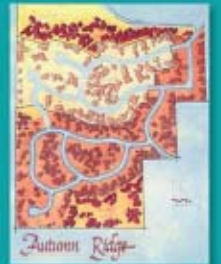

*Many other wooded lots available to choose from, bring your own builder or let us help you find just the right match! Prices start at \$56,900
Contact Don Stark, Mike Rasmussen or Elijah Krinitsyn*



13070 180th Court, Elk River

New construction. Elegant custom built 2-story built in grand style. Granite 2-story foyer, 10' ceilings, brick front, oversized windows, maple & stone flooring, whirlpool bath & separate shower. Located on a quiet cul de sac in fantastic new neighborhood. **\$394,900**
Contact Elijah Krinitsyn for more information



18850 Julie Way, Big Lake

New construction - beautiful modified 2-story. 3 BR, 3 BA and 3-car garage. Outstanding construction stands out with the open vaulted foyer, large kitchen, hardwood floors, fireplace, main floor laundry & custom marble in master bath. Easy access to highways and very near shopping, schools, lakes and trails. **\$284,900** Contact Elijah Krinitsyn for more information